

HOMER TOWNSHIP SECTION 35 R13 TWP 7 MORGAN COUNTY, OH

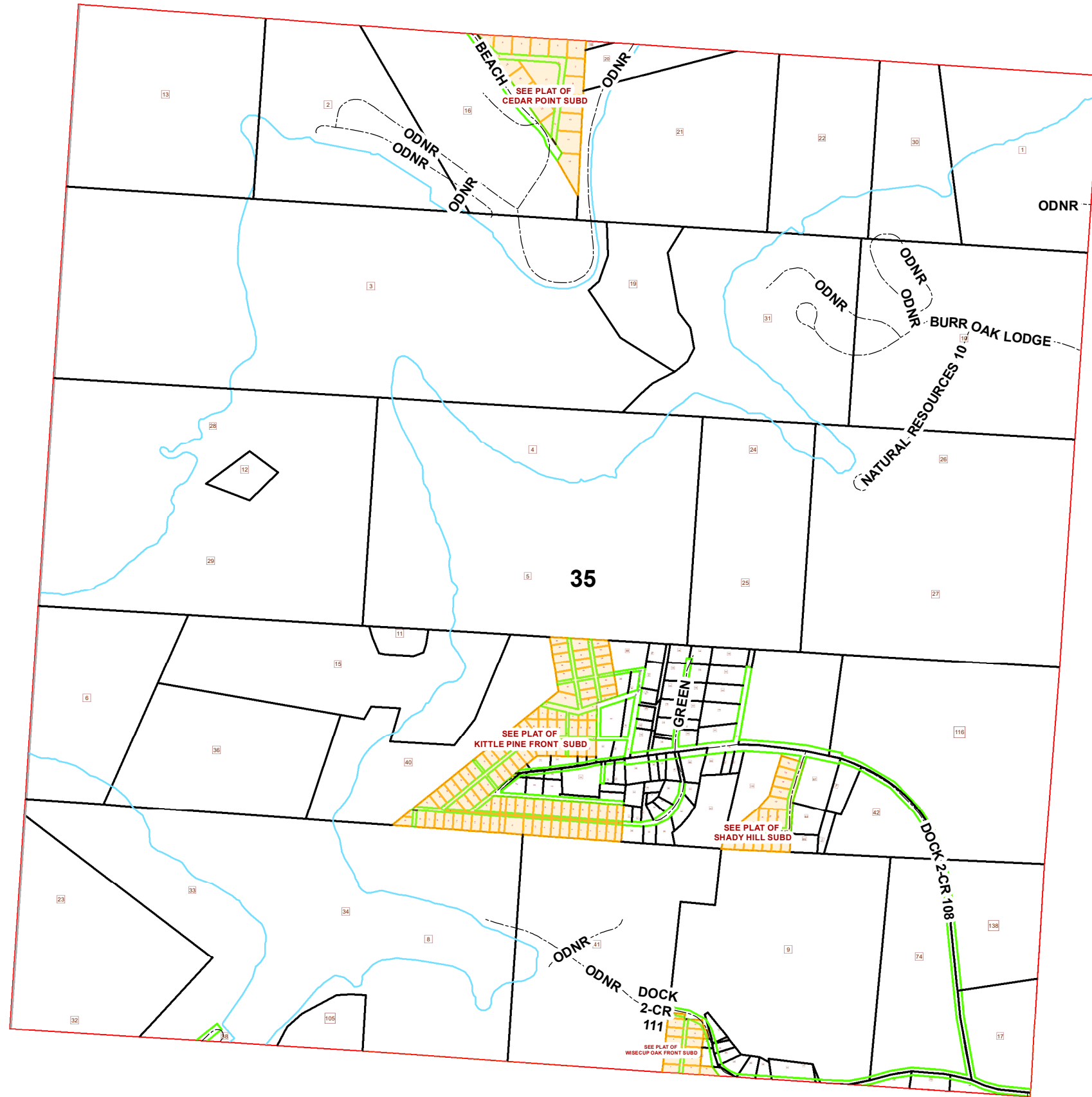

PIN	VOL	PAG	Owner	LegalDescr	Acre
050-007-120-0	OR211	1897	BARNHART SHANON & HEATHER GROV	R13 T07 S35 SD 61	0.28
050-001-870-0	OR218	1691	BARNHART SHANON RC & HEATHER GR	R13 T07 S35 SD 90	0.133
050-000-620-0	OR154	274	BARR CHARLES V OR JUDITH H TRUSTE	R13 T07 S35 SD 94	0.24
050-009-540-0	OR225	186	BARR FAMILY TRUST BARR CHARLES V	R13 T07 S35 SD 89	0.1
050-010-100-0	OR46	746	BARTLETT TERRY C & SUSAN K	R13 T07 S35 SD 9	27.09
050-007-160-0	OR67	309	BUCHANAN BRYAN & MELINDA	R13 T07 S35 SD 60	0.174
050-017-740-0	OR67	309	BUCHANAN BRYAN & MELINDA	R13 T07 S35 SD 132	0.328
050-013-760-0	OR67	309	BUCHANAN BRYAN & MELINDA	KITTLE PINE FRONT	0.507
050-007-170-0	OR67	309	BUCHANAN BRYAN & MELINDA	R13 T07 S35 SD 44	0.204
050-001-820-0	OR206	85	CUNNINGHAM JOHN D & JEAN C	R13 T07 S35 SD 100	0.545
050-006-720-0	OR143	646	DAVIS JIM L & DIANE	R13 T07 S35 SD 104	0.149
050-006-710-0	OR143	646	DAVIS JIM L & DIANE	R13 T07 S35 SD 69	0.43
050-009-530-0	OR225	639	ELAVSKY JOHN W & STACEY A	R13 T07 S35 SD 112	0.132
050-009-520-0	OR225	639	ELAVSKY JOHN W & STACEY A	R13 T07 S35 SD 111	0.218
050-009-070-0	OR225	639	ELAVSKY JOHN W & STACEY A	R13 T07 S35 SD 118	0.23
050-001-600-0	OR233	214	FAHRNEY DOUGLAS A	R13 T07 S35 SD 103	0.21
050-001-840-0	OR5	639	FRENZ THOMAS J & ALICE A	R13 T07 S35 SD 96	0.15
050-001-830-0	OR5	639	FRENZ THOMAS J & ALICE A	R13 T07 S35 SD 88	0.19
050-001-860-0	OR5	639	FRENZ THOMAS J & ALICE A	R13 T07 S35 SD 87	0.24
050-001-850-0	OR5	639	FRENZ THOMAS J & ALICE A	R13 T07 S35 SD 80	0.16
050-003-160-0	OR187	643	FRENZ THOMAS J & ALICE A	R13 T07 S35 SD 79	0.12
050-003-170-0	OR187	643	FRENZ THOMAS J & ALICE A	R13 T07 S35 SD 57	0.035
050-003-150-0	OR187	643	FRENZ THOMAS J & ALICE A	R13 T07 S35 SD 71	0.17
050-003-570-0	OR233	5735	HENDRIXSON MICHAEL DAVID	R13 T07 S35 SD 76	0.47
050-003-590-0	OR233	5735	HENDRIXSON MICHAEL DAVID	R13 T07 S35 SD 120	0.23
050-004-640-0	OR217	1281	HERD BEVERLY J	R13 T07 S35 SD 42	4.569
050-003-510-0	OR229	1290	HILL ROBERT W & KIMBERLY M	R13 T07 S35 SD 122	0.194
050-003-740-0	OR209	1061	HOHMAN MARILEE JAYE	R13 T07 S35 SD 65	0.34
050-003-730-0	OR209	1061	HOHMAN MARILEE JAYE	R13 T07 S35 SD 131	0.264
050-003-750-0	OR209	1061	HOHMAN MARILEE JAYE	R13 T07 S35 SD 83	0.586
050-005-810-0	OR232	2470	HOUCARD CHRISTINA M	R13 T07 S35 SD 68	0.462
050-004-220-0	OR218	2281	KITTLE ANDREW W	R13 T07 S35 SD 92	0.16
050-004-230-0	OR218	2281	KITTLE ANDREW W	R13 T07 S35 SD 56	0.26
050-010-140-0	OR211	3013	KITTLE ANDREW W & KARA R TABOR &	R13 T07 S35 SD 107	0.23
050-010-150-0	OR211	3013	KITTLE ANDREW W & KARA R TABOR &	R13 T07 S35 SD 108	0.23
050-001-890-0	OR228	2443	KITTLE ANDREW W & TABOR KARA	R13 T07 S35 SD 91	0.119
050-001-900-0	OR228	2443	KITTLE ANDREW W & TABOR KARA	R13 T07 S35 SD 82	0.103
050-001-880-0	OR228	2443	KITTLE ANDREW W & TABOR KARA	R13 T07 S35 SD 95	0.074
050-007-860-0	OR228	2443	KITTLE ANDREW W & TABOR KARA	R13 T07 S35 SD 86	0.239
050-004-710-1	OR213	2250	KITTLE RAYMOND WILLIAM JR	R13 T07 S35 SD 138	7.35
050-008-660-0	OR211	1953	KITTLE VIRGIL C & RUTH E	R13 T07 S35 SD 121	0.463
050-008-640-0	OR211	1953	KITTLE VIRGIL C & RUTH E	R13 T07 S35 SD 115	0.55
050-004-700-0	OR201	505	KITTLE VIRGIL C & RUTH E	R13 T07 S35 SD 7 S	6.15
050-004-710-0	D.V 164	17	KITTLE WILLIAM AKA RAYMOND W & M	R13 T07 S35 SD 17	5.57

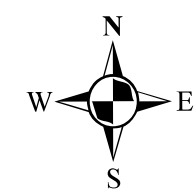

Boundaries	
----- Hidden	--- ROW
--- Hydro	--- Section
--- Roads	--- Lot
--- County	--- Township
--- Parcel	--- Parcels

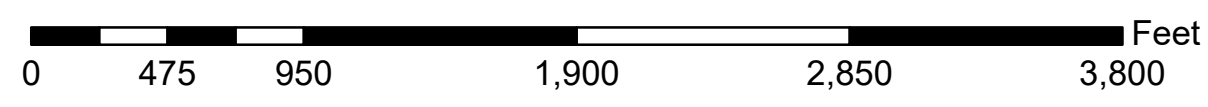

Disclaimer: The information that these maps contains is for reference purposes only. Please bring any errors to the attention of the Engineer's Office staff.
Thank you

Source: Morgan County Engineer's Office
Author: Marcia Wolfe
Date: 6/8/2020

HOMER TOWNSHIP SECTION 35 R13 TWP 7 MORGAN COUNTY, OH

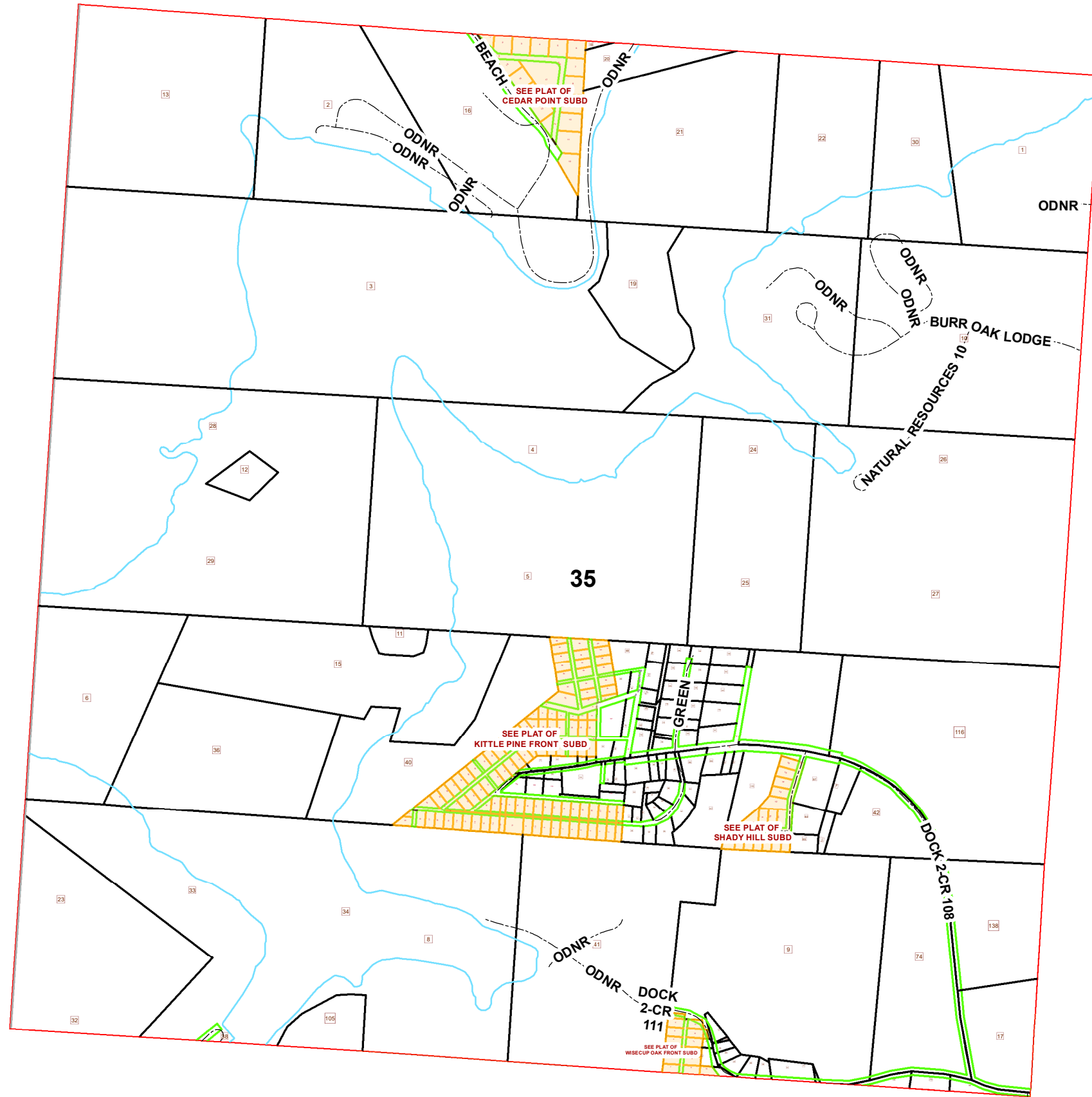

PIN	VOL	PAG	Owner	LegalDescr	Acre
050-004-370-0	OR172	598	KLEINLEIN LARRY & PAMELA	R13 T07 S35 SD 98	0.37
050-004-360-0	OR172	598	KLEINLEIN LARRY & PAMELA	R13 T07 S35 SD 99	0.16
050-005-420-0	OR231	4702	KLEINLEIN LARRY H & PAMELA S	R13 T07 S35 SD 67	0.22
050-008-670-0	OR157	737	KLEINLEIN PAMELA S	R13 T07 S35 SD 72	0.154
050-002-910-0	OR222	1819	KOON CHRISTOPHER L	R13 T07 S35 SD 77	0.105
050-013-360-0	OR222	1819	KOON CHRISTOPHER L	KITTLE PINE FRONT	0
050-005-380-0	OR209	1158	LEVERING LARRY E FAMILY TRUST	R13 T07 S35 SD 128	0.459
050-014-080-0	OR27	394	MADISON MARGIE KAY	KITTLE PINE FRONT	0
050-010-000-0	OR27	394	MADISON MARGIE KAY	R13 T07 S35 SD 58	0.08
050-013-780-0	OR215	1479	MCCOLLUM JOSEPH G & RICHARD L	KITTLE PINE FRONT	0.193
050-007-730-0	OR215	1479	MCCOLLUM JOSEPH G & RICHARD L	R13 T07 S35 SD 50	0.117
050-006-070-1	OR215	1479	MCCOLLUM JOSEPH G & RICHARD L	R13 T07 S35 SD 139	0.021
050-000-150-0	OR222	3126	MCKENNA JEFFREY A & SUZANNE ROIE	R13 T07 S35 SD 105	2.411
050-009-920-0	OR202	35	MCLAUGHLIN MARION L	R13 T07 S35 SD 102	0.275
050-008-420-0	OR202	35	MCLAUGHLIN MARION L	R13 T07 S35 SD 62	0.14
050-008-430-0	OR202	35	MCLAUGHLIN MARION L	R13 T07 S35 SD 63	0.18
050-004-640-1	OR203	1438	MOORE JUDY M & KEITH A	R13 T07 S35 SD 136	0.692
050-010-030-0	OR203	1438	MOORE JUDY M & KEITH A	R13 T07 S35 SD 97	1.09
050-007-580-0	OR232	4456	NUTTER RONNIE D JR	R13 T07 S35 SD 127	0.459
050-007-960-0	OR229	1284	PRITCHARD DAVID F & DOROTHY C	R13 T07 S35 SD 66	0.18
050-003-620-0	OR229	1280	PRITCHARD DAVID F & DOROTHY C	R13 T07 S35 SD 49	0.117
050-003-600-0	OR229	1280	PRITCHARD DAVID F & DOROTHY C	R13 T07 S35 SD 48	0.668
050-007-640-0	OR217	2143	PUGLIESE GEOFFREY A & MELISSA COY	R13 T07 S35 SD 35	0.441
050-006-590-0	OR176	112	RADCLIFF CHARLES M TRUSTEE	R13 T07 S35 SD 113	0.23
050-006-050-0	OR176	112	RADCLIFF CHARLES M TRUSTEE	R13 T07 S35 SD 114	0.254
050-006-060-0	OR227	3448	RADCLIFF CHARLES M TRUSTEE OF THE	R13 T07 S35 SD 106	0.254
050-004-650-0	OR218	2655	RICHARDS TODD M	R13 T07 S35 SD 74	10.79
050-005-821-0	OR233	1723	ROBINSON HERBERT & JOYCE R	R13 T7 S35 SD 140	0.042
050-007-340-0	OR75	470	ROBINSON HERBERT & JOYCE R	R13 T07 S35 SD 123	0.06
050-005-820-0	OR75	470	ROBINSON HERBERT & JOYCE R	R13 T07 S35 SD 51	0.23
050-004-420-0	OR213	2837	RUSHING KATHY JO MALONE & WILLIAM	R13 T07 S35 SD 73	0.435
050-001-930-0	OR218	3270	SCHWARZENBERG KERRY SUE TOD-SO	R13 T07 S35 SD 101	0.314
050-002-440-0	OR218	3270	SCHWARZENBERG KERRY TOD-SOPHIA	R13 T07 S35 SD 117	2.04
050-002-420-0	OR218	3270	SCHWARZENBERG KERRY TOD-SOPHIA	R13 T07 S35 SD 109	0.14
050-002-430-0	OR218	3270	SCHWARZENBERG KERRY TOD-SOPHIA	R13 T07 S35 SD 81	0.14
050-008-650-0	OR218	3270	SCHWARZENBERG KERRY TOD-SOPHIA	R13 T07 S35 SD 130	1.644
050-004-030-0	OR203	1645	SCOTT ROBERT E & JULIA MICHAEL	R13 T07 S35 SD 52	0.02
050-004-010-0	OR203	1645	SCOTT ROBERT E & JULIA MICHAEL	R13 T07 S35 SD 53	0.16
050-004-020-0	OR203	1645	SCOTT ROBERT E & JULIA MICHAEL	R13 T07 S35 SD 54	0.063

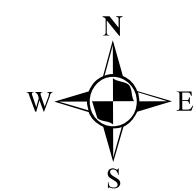

Boundaries	
----- Hidden	--- ROW
--- Hydro	--- Section
--- Roads	--- Lot
--- County	--- Township
--- Parcel	--- Parcels



Disclaimer: The information that these maps contains is for reference purposes only. Please bring any errors to the attention of the Engineer's Office staff.
Thank you

Source: Morgan County Engineer's Office
Author: Marcia Wolfe
Date: 6/8/2020

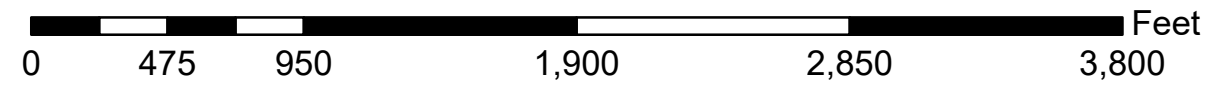

HOMER TOWNSHIP SECTION 35 R13 TWP 7 MORGAN COUNTY, OH

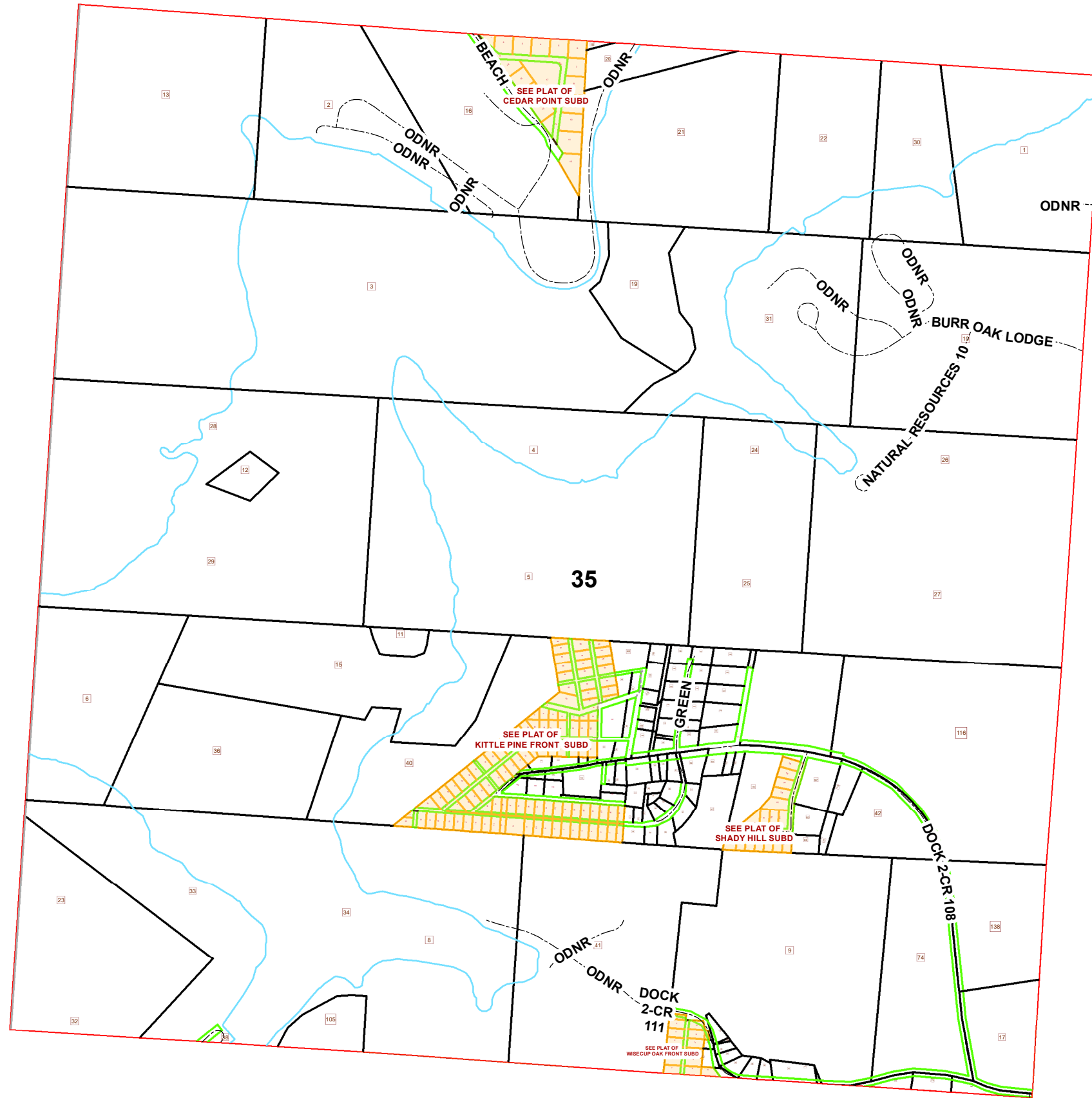

PIN	VOL	PAG	Owner	LegalDescr	Acre
050-002-100-0	OR207	1769	SIX YVONNE K	R13 T07 S35 SD 126	0.23
050-000-960-0	OR232	4641	SIX YVONNE K	R13 T07 S35 SD 43	0.31
050-000-980-0	OR232	4641	SIX YVONNE K	R13 T07 S35 SD 46	0.19
050-004-690-0	OR230	1421	SMITH PHILLIP & KITTLE OLIVIA R	R13 T07 S35 SD 116	25.25
050-600-580-0	OR97	153	STATE OF OHIO	R13 T07 S35 LOT 41	26.5
050-600-370-0	D.V 97	269	STATE OF OHIO	R13 T07 S35 LOT 8	32
050-600-550-0	D.V 94	180	STATE OF OHIO	R13 T07 S35 LOT 36	15
050-600-570-0	D.V 97	429	STATE OF OHIO	R13 T07 S35 LOT 40	12.25
050-600-390-0	D.V 94	240	STATE OF OHIO	R13 T07 S35 LOT 11	1
050-600-420-0	D.V 94	181	STATE OF OHIO	R13 T07 S35 LOT 15	19
050-600-360-0	D.V 97	269	STATE OF OHIO	R13 T07 S35 LOT 6	14.93
050-600-400-0	D.V 94	240	STATE OF OHIO	R13 T07 S35 LOT 12	1.11
050-600-500-0	D.V 94	422	STATE OF OHIO	R13 T07 S35 LOT 26	40
050-600-490-0	D.V 94	422	STATE OF OHIO	R13 T07 S35 LOT 24	17.41
050-600-310-0	D.V 94	240	STATE OF OHIO	LOT 4-5	40.13
050-600-510-0	D.V 94	240	STATE OF OHIO	R13 T07 S35 LOT 28	48.89
050-600-380-0	D.V 94	422	STATE OF OHIO	R13 T07 S35 LOT 10	30
050-600-530-0	D.V 94	422	STATE OF OHIO	R13 T07 S35 LOT 31	24.2
050-600-450-0	D.V 94	422	STATE OF OHIO	R13 T07 S35 LOT 19	5.66
050-600-350-0	D.V 94	184	STATE OF OHIO	R13 T07 S35 LOT 3	63.14
050-600-330-0	D.V 94	422	STATE OF OHIO	R13 T07 S35 LOT 1	17.8
050-600-680-0	D.V 94	422	STATE OF OHIO	R13 T07 S35 LOT 30	8.5
050-600-480-0	D.V 94	422	STATE OF OHIO	R13 T07 S25 LOT 22	12
050-600-470-0	D.V 94	422	STATE OF OHIO	R13 T07 S35 LOT 21	20.75
050-600-460-0	D.V 94	422	STATE OF OHIO	R13 T07 S35 LOT 20	2.2
050-600-440-0	D.V 94	422	STATE OF OHIO	R13 T07 S35 LOT 18	0.1
050-600-430-0	D.V 96	143	STATE OF OHIO	R13 T07 S35 LOT 16	14.8
050-600-340-0	D.V 96	136	STATE OF OHIO	R13 T07 S35 LOT 2	18.55
050-600-410-0	D.V 94	422	STATE OF OHIO	R13 T07 S35 LOT 13	23
050-013-980-0	D.V 117	145	TIEDTKE FREDERICK W & TATE TIEDTKE UI	KITTLE PINE FRONT UNK	0 0
050-008-260-0	OR224	799	WALLACE FRED M & KATHY J	R13 T07 S35 SD 23-	18.01
050-013-710-0	OR214	3470	WARD RONALD & DARLENE	KITTLE PINE FRONT	0.198
050-009-140-0	OR78	435	WOOD CHARLES R & FLORENCE LC-DA	R13 T07 S35 SD 124	0.454

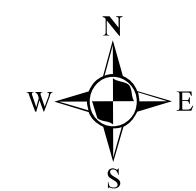

Boundaries	
----- Hidden	--- ROW
--- Hydro	--- Section
--- Roads	--- Lot
--- County	--- Township
--- Parcel	--- Parcels



Disclaimer: The information that these maps contains is for reference purposes only. Please bring any errors to the attention of the Engineer's Office staff.
Thank you

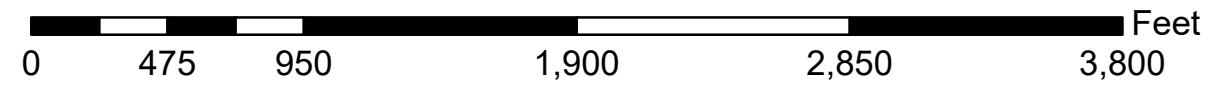

Source: Morgan County Engineer's Office
Author: Marcia Wolfe
Date: 6/8/2020